

- 8 inches SVGA / XGA.
- Wide viewing angle and high brightness.
- Integrated ATOM E38XX or Quad Core ARM CPU.
- Optional touch panel.
- Fully configurable manual and automatic dimmer.
- Slim frame.
- Wide power supply options available.
- Extended range operating temperature.
- LED backlight lifetime min. 50.000h.



| General Specification | |
|----------------------------|--|
| Size | 8 inches |
| Resolution / Aspect | 800 x 600 / 1024 x 768px / 4:3 |
| Inputs | Ethernet / WiFi |
| Audio | Optional Audio Output |
| Touch | Resistive 5 Wires / Projected Capacitive |
| Power Supply | 9-36V DC / 43-160VDC / 14-160VDC |
| Power Consumption | 18W (300 nits) / 27W (750 nits) |
| MTBF / Lifespan | Controller and LCD: 100.000h Backlight: min. 50.000h |
| Warranty | 24 months |
| Certification | CE |
| Mounting Type | Stand Alone, rear custom fixtures |
| Mechanical and Environment | |
| Dimension | (see drawing for details) |
| Weight | 2Kg |
| Enclosure | Steel and Aluminum, Powder Paint |
| Operation Temp. | -20°C to 70°C |
| Storage Temp. | -20°C to 70°C |
| Vibrations / Shock | 1G 2-500Hz / 10G 11ms |
| Optical Specification | |
| Brightness | 500/1000 nits, LED backlight. |
| Dimmer | Fully configurable Dimmer with Internal Sensor (included) and External Sensor (optional) |
| Contrast ratio | 1000:1 |
| Viewing Angle | 178° H, 178° V |
| Response Time | 16 ms |
| Optical Finish | Anti-glare/Anti-reflective |
| Enhancements | Sunlight Readable and Transflective Enhancements Available |

Inelmatic Electronics Service Centers
 Europe: Valladolid (Spain)
 Asia: Shanghai (China),
 Americas: Florida (USA), Ontario (Canada),
 Australia: Perth & Melbourne (Australia)

| CPU Specification (ARM) | |
|---------------------------|---|
| Cores | Quad-core ARM Cortex-A17 |
| Frequency | 1.8GHz |
| DDR | Upto 4G DDR4 |
| Graphics | Mali-T760 MP4 GPU |
| Storage | Internal 8 to 16G eMMC , external TF/SD |
| Watchdog | Configurable watchdog |
| CPU Specification (Intel) | |
| Cores | E3815 Single Core / E3825 Dual Core / E3845 Quad Core |
| Frequency | 1.46Ghz / 1.33Ghz / 1.91Ghz |
| DDR | Upto 4G DDR4 |
| Graphics | Intel Graphics |
| Storage | Internal 8 to 16G eMMC , external C-FAST |
| Watchdog | Configurable watchdog |
| I/O | |
| Ethernet | 1 x Base10/100, Optional Gigabit, M12 Connector D Coded |
| USB | USB 2.0 x 1 Type A |
| Ignition | Integrated digital input for IGN control |
| RS232/485 | RS232 / RS485 Port (M12 Connector) |
| Digital I/O | 8 Input or 4 in 4 Out optional |
| Video | Optional DVI / HDMI Output |
| Audio | Optional Line In / Line Out |

Drawing

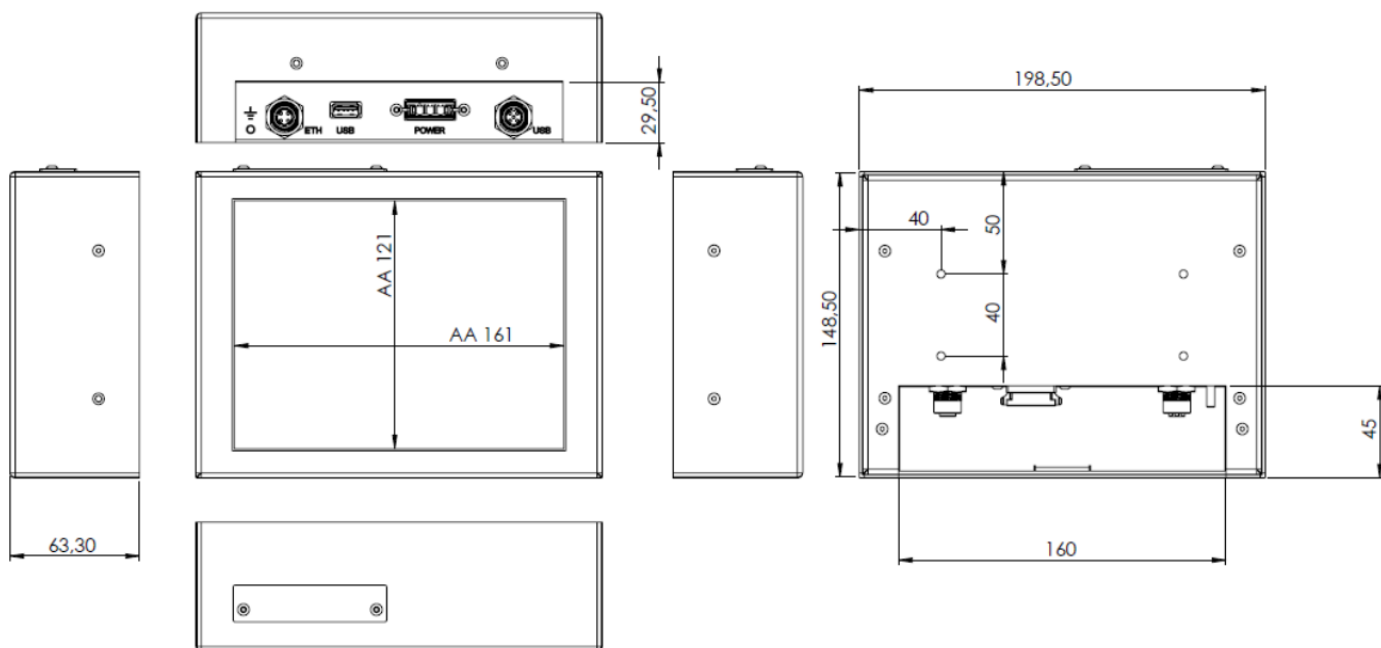

Inelmatic Electronics Service Centers
 Europe: Valladolid (Spain)
 Asia: Shanghai (China),
 Americas: Florida (USA), Ontario (Canada),
 Australia: Perth & Melbourne (Australia)

Images



Ordering Information

| Model | CPU | RAM/Flash | I/O | Interfaces | Power Supply | Brightness | Touch/Cover |
|------------------------------|--------|-----------|------|------------|--------------|------------|-------------|
| ED800-NN-3388-208-000-2ND2-1 | ARM 4Q | 2G / 8G | None | Ethernet | 9-36VDC | 500 nits | None |
| ED800-NN-3825-208-000-2ND2-1 | E3825 | 2G / 32G | None | Ethernet | 9-36VDC | 500 nits | None |
| | | | | | | | |
| | | | | | | | |
| | | | | | | | |

Accessories

| | |
|--|--|
| | |
| | |
| | |

Inelmatic Electronics Service Centers
 Europe: Valladolid (Spain)
 Asia: Shanghai (China),
 Americas: Florida (USA), Ontario (Canada),
 Australia: Perth & Melbourne (Australia)